

Cygnet Hygiene, Round Cistern, Back Inlet

American Standard

Kit Code: CYGNETRDBKIN

Pan: CL3324B-6DACTBF
Cistern: CL43244-6DACTBI
Seat: CL6157M-6D

Recommended Domestic, hotel and commercial

KEY SPECIFICATIONS

- Finish: White
- Material: Pan: Vitreous China, Cistern: Vitreous China, Seat: Urea
- Inlet valve pressure rating: 500kPa
- Inlet position: Back inlet
- Outlet type: Universal S & P, P trap (converts to S trap using plastic S bend provided)
- Rim configuration: Hygiene Rim
- Technologies: Double vortex flushing,
- S trap set out: 140-260mm
- P trap set out: 190mm
- Toilet seat: Soft close quick release seat



WARRANTY

- Domestic use
- 10 years product replacement, 1 year (cistern) parts and labour

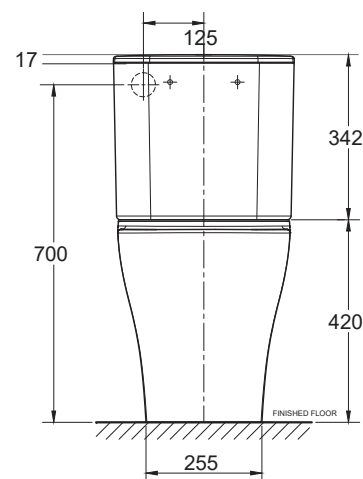
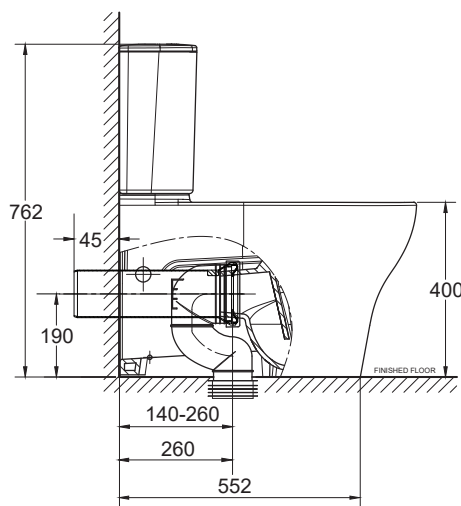
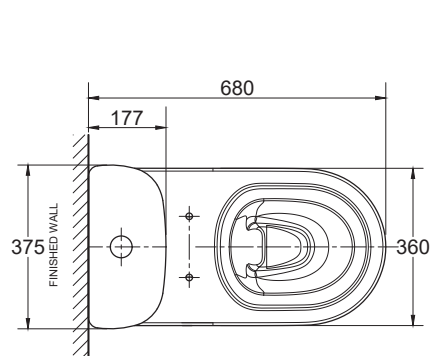

MONACO

Monaco Customer Call Centre: +64 9 415 6000
sales@monacocorp.co.nz

www.monacocorp.co.nz

Disclaimer: Products in this specification manual must by regulation be installed by licensed and registered trade people. The manufacturer/distributor reserves the right to vary specifications or delete models from their range without prior notification. Dimensions are nominal measurements only. Dimensions and set-outs listed are correct at time of publication however the manufacturer/distributor takes no responsibility for printing errors.
Published 11/11/24

